

Installation Instructions ***APEX® CORE*** ***Operator Cover***

**CORNELLCOOKSON TECHNICAL
SUPPORT DEPARTMENT**
("CC TECHNICAL SUPPORT")
800-233-8366



The instructions contained below are supplemental to the instructions received with your door/operator. Please review those instructions for any installation, safety, freight receiving and all other instructions prior to use of these instructions.

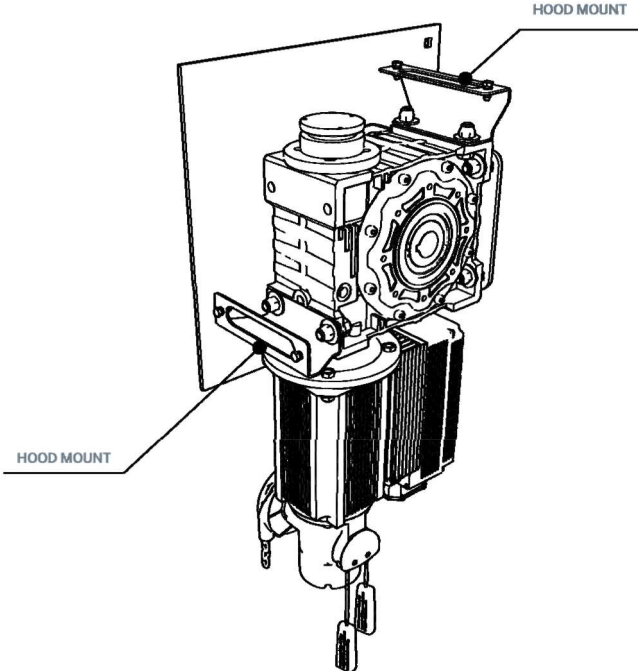

Figure 1 – Motor Cover Mounts

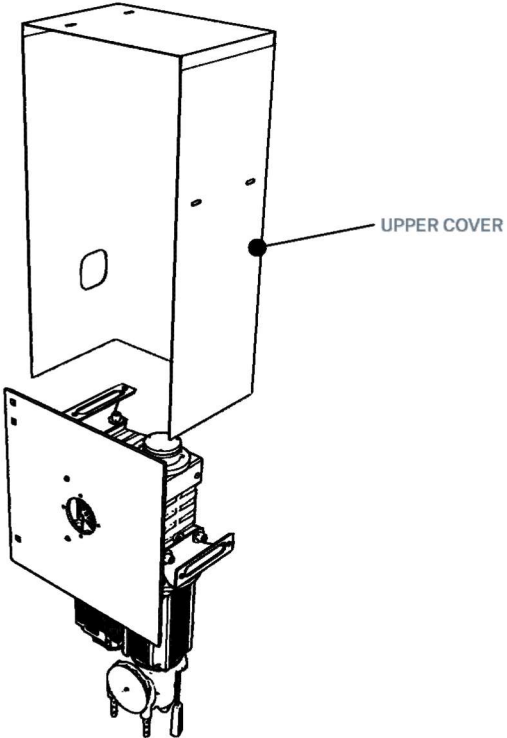

Figure 2 – Upper Cover

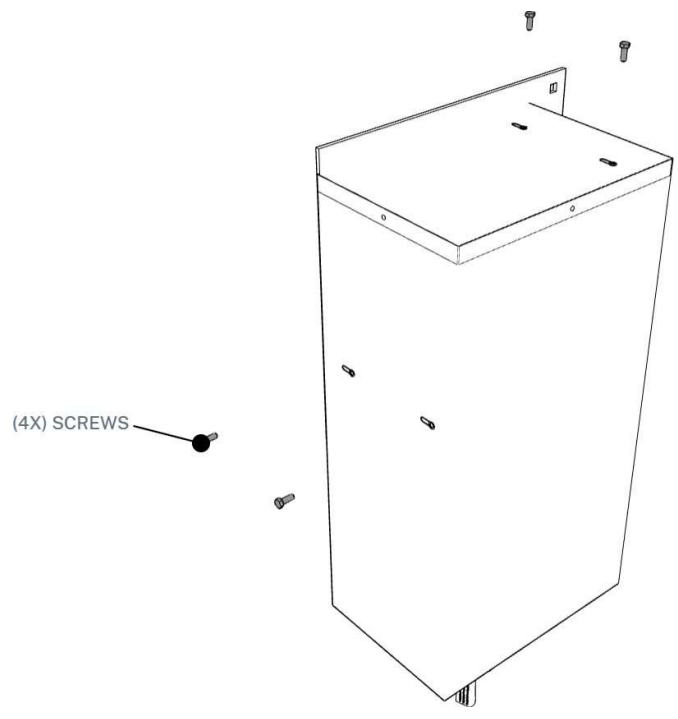

Figure 3 – Bolting Upper Cover

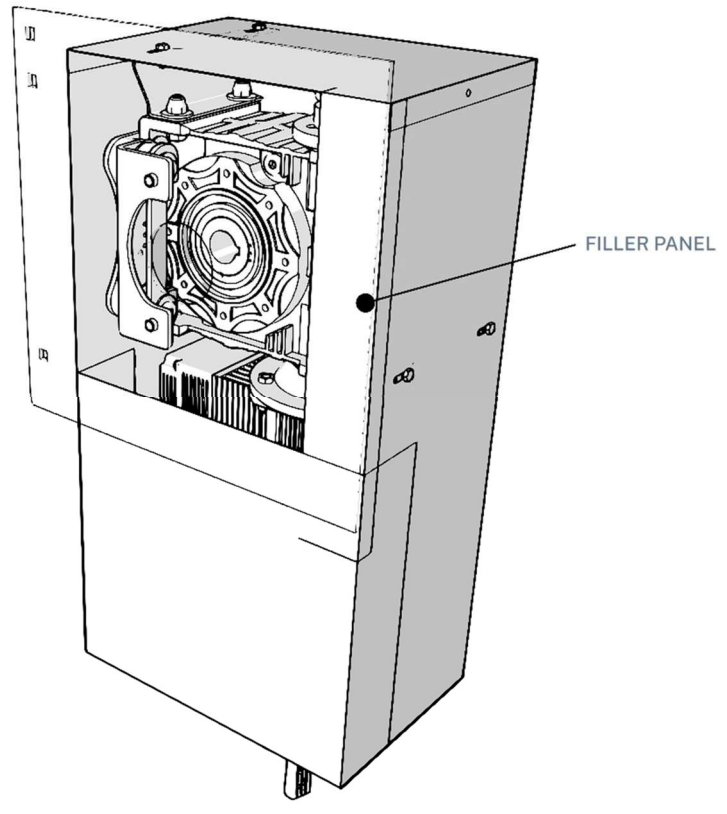

Figure 4 – Cover Filler

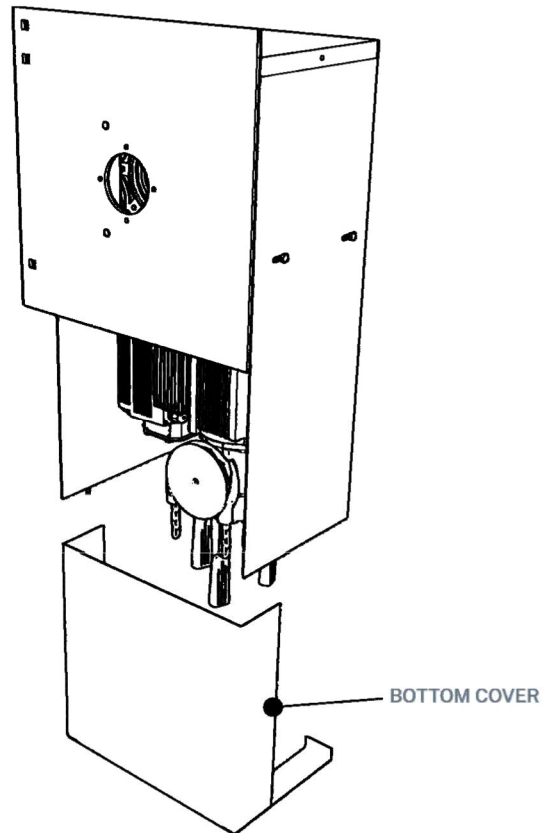

Figure 5 – Bottom Cover

1. Following the successful installation and functional testing of the door assembly, the motor cover may be installed.
2. Install the (2) **HOOD MOUNT BRACKETS** with the provided (4) 1/2-13 x 1.5" included hardware as shown in **Figure 1**.
3. From the side, installed the **FRONT/TOP COVER**, which comes riveted together, attaching it to the **HOOD MOUNT BRACKETS**. Reference **Figure 2** for installation.
4. Bolt the **FRONT/TOP COVER** to the **HOOD MOUNT BRACKETS** using the provided (4) 1/4-20 x 0.75" screws, shown in **Figure 3**. Route the wiring flexible conduit and the controller cable through the rear access hole after installation.
5. For smaller bracket sizes, if there is a gap between the bracket and the **FRONT/TOP COVER**, install the **COVER FILLER**, attaching it to the **FRONT/TOP COVER** on the front of the bracket using (2) provided 10-16 x 1/2" tap screws. See **Figure 4** for reference.
6. From below, slide the **BOTTOM COVER** into place in between the **COVER FILLER** piece (if required) and the bracket. See **Figure 5** for reference.
7. Secure the **BOTTOM COVER** to the **FRONT/TOP COVER** using the remaining 10-16 x 1/2" tap screws as shown in **Figure 5** to secure it in place.