

MODEL 3154, 230B (RAISED PANEL EMBOSS)  
MODEL 3155 (FLUSH)

REVISIONS

REV. NO.	ZONE	DATE	ECN NO.	APPVD:	DESCRIPTION
00	-	11/03/03	ER1037	SH	INITIAL RELEASE
01	-	1/09/07	-	SH	DRAWING_CORRECTIONS

D

C

B

A

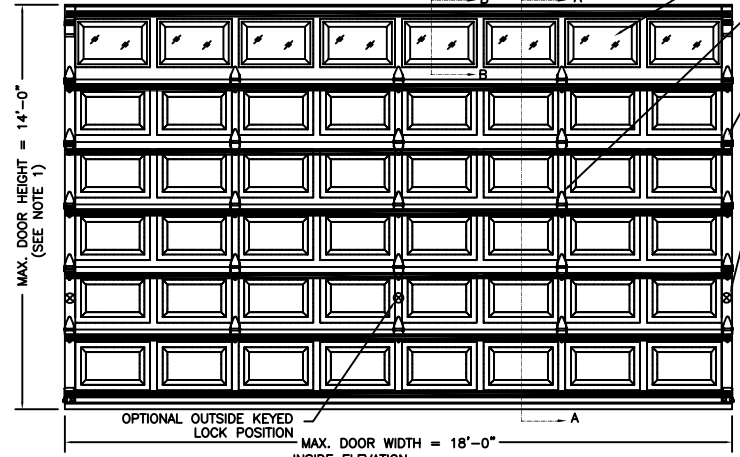

OPTIONAL WINDOW LITES AVAILABLE (SEE SECTION B-B)

SEE INTERMEDIATE HINGE DETAIL

SEE END HINGE DETAIL

LOCK POSITION ONE POINT (MIN) LOCKING

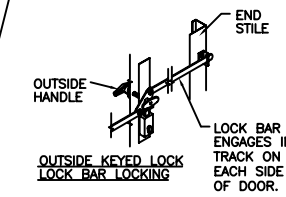

SNAP LATCH ENGAGES ONTO VERTICAL TRACK. ONE SNAP LATCH ON EACH SIDE OF DOOR.

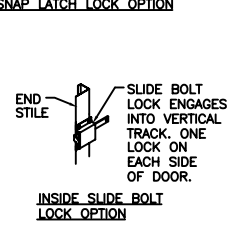
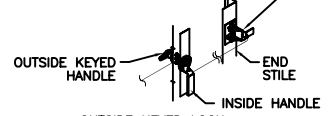

SECTION B-B

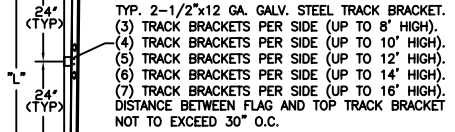
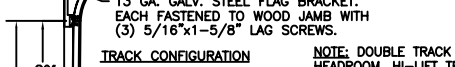
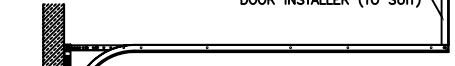
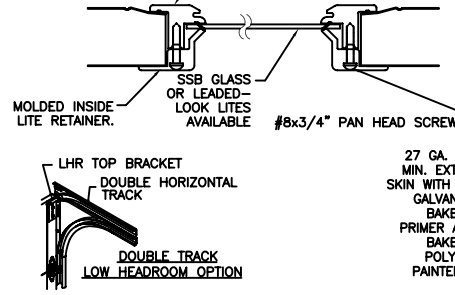

DOOR HEIGHT	"L"	DOOR HEIGHT	"L"
6'-6"	70"	11'-6"	130"
7'-0"	76"	12'-0"	136"
7'-6"	82"	12'-6"	142"
8'-0"	88"	13'-0"	148"
8'-6"	94"	13'-6"	154"
9'-0"	100"	14'-0"	160"
9'-6"	106"	14'-6"	166"
10'-0"	112"	15'-0"	172"
10'-6"	118"	15'-6"	178"
11'-0"	124"	16'-0"	184"

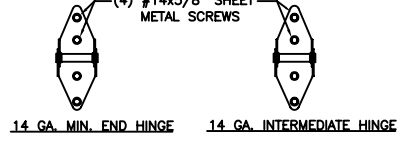
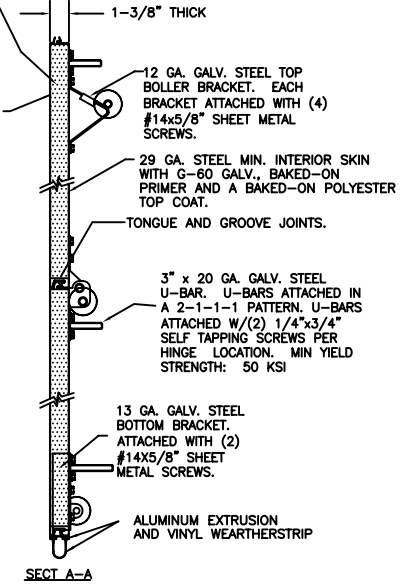

NOTE 1:  
DOORS UP TO 7'-0" HIGH CONSIST OF (4) SECTIONS (NOT SHOWN)  
DOORS 7'-3" TO 8'-9" HIGH CONSIST OF (5) SECTIONS (NOT SHOWN).  
DOORS 9'-0" TO 10'-6" HIGH CONSIST OF (6) SECTIONS (SHOWN).  
DOORS 10'-9" TO 12'-3" HIGH CONSIST OF (7) SECTIONS (NOT SHOWN).  
DOORS 12'-6" TO 14'-0" HIGH CONSIST OF (8) SECTIONS (NOT SHOWN).  
DOORS 14'-3" TO 15'-9" HIGH CONSIST OF (9) SECTIONS (NOT SHOWN).  
DOORS 16'-0" HIGH CONSIST OF (10) SECTIONS (NOT SHOWN).

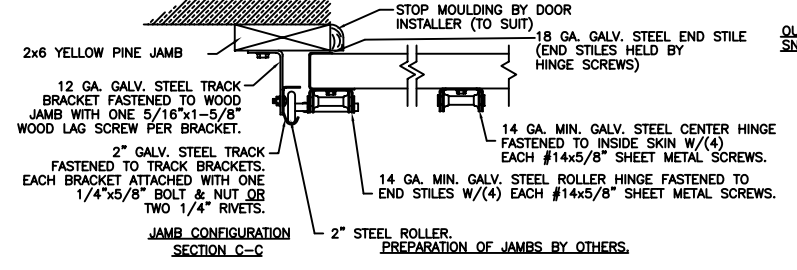

ANCHOR NOTE: FIRST (BOTTOM) ANCHOR STARTING AT NO MORE THAN HALF OF THE MAXIMUM ON-CENTER DISTANCE. HIGHEST ANCHOR INSTALLED AT LEAST AS HIGH AS THE DOOR OPENING.

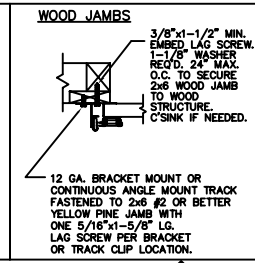
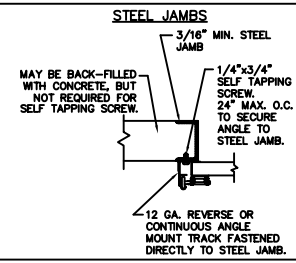
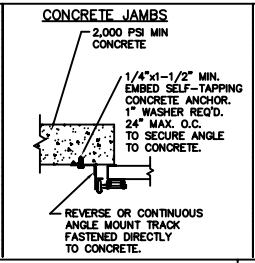
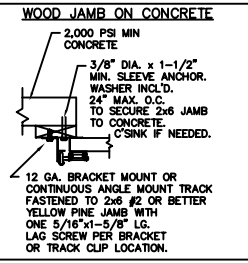

THE DESIGN OF THE SUPPORTING STRUCTURAL ELEMENTS IS THE RESPONSIBILITY OF THE BUILDING ENGINEER OR ARCHITECT OF RECORD.

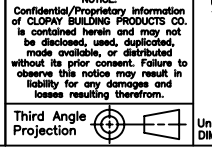

Unless Stated Otherwise TOLERANCES are  
.0 = ±.03  
.00 = ±.015  
.000 = ±.005  
.0000 = ±.001  
Degrees = ±1/2

DESIGN LOADS: +12.5 PSF & -14 PSF  
TEST LOADS: +19 PSF & -21 PSF

8585 Duke Boulevard  
Mason, OH 45040  
Tel. No. 1-513-381-4800  
Fax No. 1-513-762-3519

DESCRIPTION: MODEL 3154W1 18'0" WIDE		PART NO.:	
DRAWN BY: SH	DATE: 10/20/03	SCALE: NTS	DWG. B
CHECKED BY:	DATE:	SHEET 1 OF 1	SIZE
DWG. NO.: 102983	REV. NO. 01		

4

3

2

1