

MODEL 3203, 250 (RAISED PANEL EMBOSS)
MODEL 3201 (FLUSH)

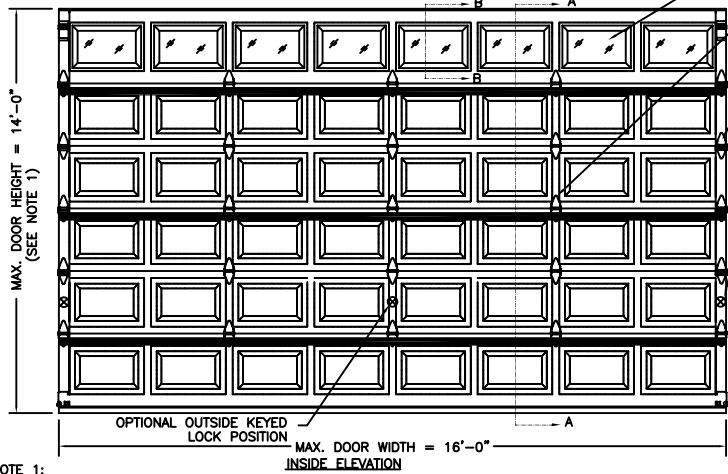

NOTE 1:
DOORS UP TO 7'-0" HIGH CONSIST OF (4) SECTIONS (NOT SHOWN).
DOORS 7'-3" TO 8'-9" HIGH CONSIST OF (5) SECTIONS (NOT SHOWN).
DOORS 9'-0" TO 10'-6" HIGH CONSIST OF (6) SECTIONS (SHOWN).
DOORS 10'-9" TO 12'-3" HIGH CONSIST OF (7) SECTIONS (NOT SHOWN).
DOORS 12'-6" TO 14'-0" HIGH CONSIST OF (8) SECTIONS (NOT SHOWN).
DOORS 14'-3" TO 15'-9" HIGH CONSIST OF (9) SECTIONS (NOT SHOWN).
DOORS 16'-0" HIGH CONSIST OF (10) SECTIONS (NOT SHOWN).

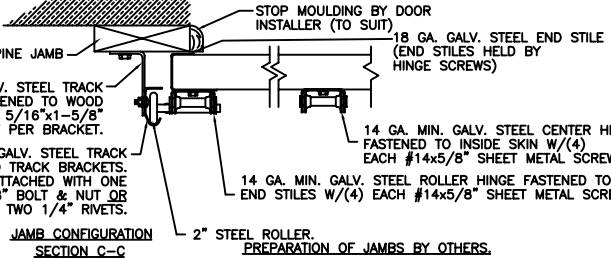

ANCHOR NOTE: FIRST (BOTTOM) ANCHOR STARTING AT NO MORE THAN HALF OF THE MAXIMUM ON-CENTER DISTANCE. HIGHEST ANCHOR INSTALLED AT LEAST AS HIGH AS THE DOOR OPENING.

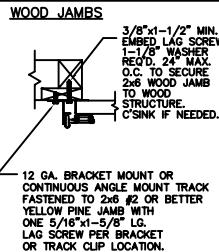
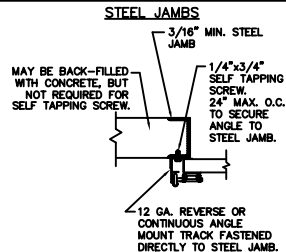
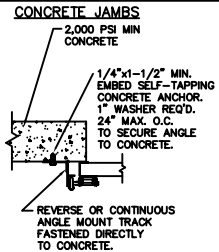
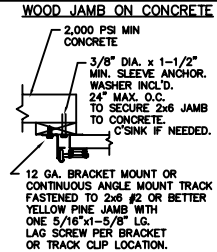

THE DESIGN OF THE SUPPORTING STRUCTURAL ELEMENTS IS THE RESPONSIBILITY OF THE BUILDING ENGINEER OR ARCHITECT OF RECORD.

NOTICE: Confidential/Proprietary information of CLOPAY BUILDING PRODUCTS CO. is contained herein and may not be disclosed, used, duplicated, made available, or distributed without the prior consent. Failure to observe this notice may result in liability for any damages and losses resulting therefrom.



Unless Stated Otherwise TOLERANCES are
.0 = ±.03
.00 = ±.015
.000 = ±.005
.0000 = ±.001
Degrees = ±1/2°

Unless Stated Otherwise DIMENSIONS ARE IN INCHES.

| DOOR HEIGHT | "L" | DOOR HEIGHT | "L" |
|-------------|------|-------------|------|
| 6'-6" | 70" | 11'-6" | 130" |
| 7'-0" | 76" | 12'-0" | 136" |
| 7'-6" | 82" | 12'-6" | 142" |
| 8'-0" | 88" | 13'-0" | 148" |
| 8'-6" | 94" | 13'-6" | 154" |
| 9'-0" | 100" | 14'-0" | 160" |
| 9'-6" | 106" | 14'-6" | 166" |
| 10'-0" | 112" | 15'-0" | 172" |
| 10'-6" | 118" | 15'-6" | 178" |
| 11'-0" | 124" | 16'-0" | 184" |

DESIGN LOADS: +12.5 PSF & -14 PSF
TEST LOADS: +19 PSF & -21 PSF

PART NO.:

Clopay 8585 Duke Boulevard
Mason, OH 45040
Tel. No. 1-513-381-4800
Building Products Company Fax No. 1-513-762-3519

DESCRIPTION: MODEL 3203W1 16'0" WIDE

| | | | |
|------------------|---------------|--------------|-------------|
| DRAWN BY: DAS | DATE: 5/27/03 | SCALE: NTS | DWG. B |
| CHECKED BY: | DATE: | SHEET 1 OF 1 | SIZE |
| DWG. NO.: 102885 | | | REV. NO. 00 |

| REVISIONS | | | | | |
|-----------|------|----------|---------|--------|---------------------|
| REV. NO. | ZONE | DATE | ECN NO. | APPVD: | DESCRIPTION |
| 00 | - | 11/03/03 | ER1037 | SH | INITIAL RELEASE |
| 01 | - | 1/09/07 | - | SH | DRAWING_CORRECTIONS |

